

SPECIFICATION FOR APPROVAL

Material

Production:	Super Sendust Cores
FUAN.P/N:	KS226-060A-HF
AL:	138(nH/N ²)±8%
Material:	60 μ
Coating Color:	Black
Coating material:	epoxy
Coating Breakdown Voltage:	1000V, 0.5mA, 2Sec

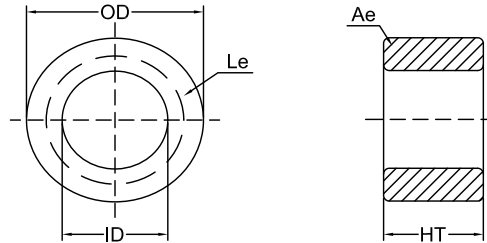

Physical Characteristics

Before Coating			After Coating			Le(cm)	Ae(cm ²)	V(cm ³)	W(cm ²)	Weight (g) (ref.)	Box Quantity (Pieces)
OD(Max.) in/mm	ID(Min.) in/mm	Ht(Max.) in/mm	OD(Max.) mm	ID(Min.) mm	Ht(Max.) mm						
2.252 57.20	1.039 26.40	0.598 15.20	58.00	25.60	16.10	12.500	2.290	28.600	5.145	183.3	96

Electrical Parameters(Typical) Temperature(25°C±2°C)

Test Item	Test Condition	Value(Typical)	Test Instrument
Inductance	φ0.80mm/66Ts, 20kHz/1V, I=0A (Evenly full windings)	601.1μH±8%	CH3302
DC-Bias	φ0.80mm/66Ts, 20kHz/1V, I=15A(H=100Oe) (Evenly full windings)	337.3μH(Min.)	WK3255B+WK3265B
Core Loss	50kHz/1000Gs	370mW/cm ³ (Max.)	SY-8219
Remarks	Set the internal resistance of LCR meter to 100Ω.		

Core Loss Curves(Typical)

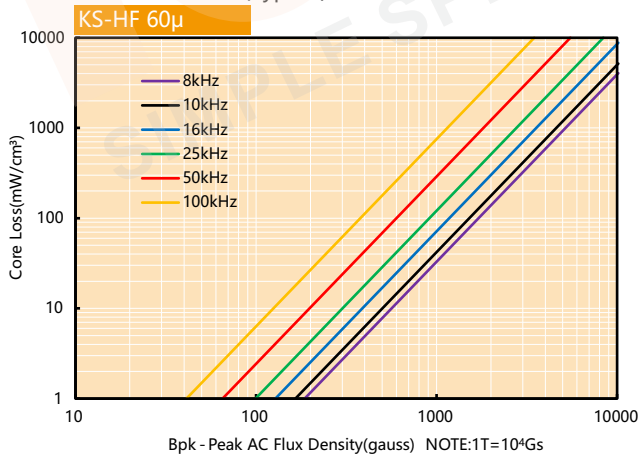

DC-Bias Curves(Typical)

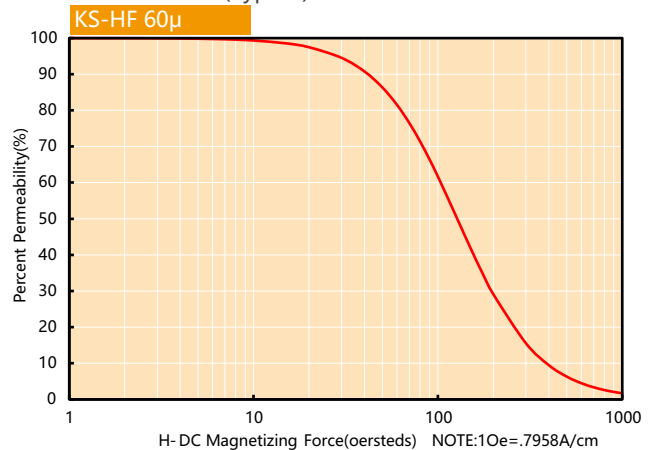

Super Sendust Cores (KS-HF Series) is a new type of magnetic material which has good DC bias characteristics close to Si-Fe cores with core losses similar to Sendust Cores. High permeability KS-HF cores (75-125μ) will be an economic solution for applications which require high permeability such as low power switching power supply, server power, automotive, solar power. KS-HF cores with low permeability (26-60μ) are applied to various large current applications which lower losses and excellent DC bias characteristics are critical. They are applied to various applications such as UPS, power Inverter, industrial power.