

TELECOM TRANSFORMERS FAEP SERIES

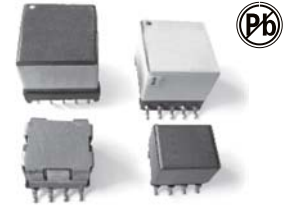

FEATURES

Low inFATERwind capacitance
Low total harmonic distortion(THD)
Compact size and Surface-mounted
Designed to meet UL, CSA, VDE, BABT safety standard

OPTIONS

Tape and reel is standard
Bulk packaging available for Smaller quantities
Custom design available
Tolerance: 5% is standard,
Tigh FATER tolerance available

COMMON APPLICATIONS

Modem
Fax machine, Hub
ISDN, ADSL, HDSL, PABX
Other telecommunication facilities etc
Switching power supplies
AC-DC, DC-DC converters

TECHNICAL INFORMATION

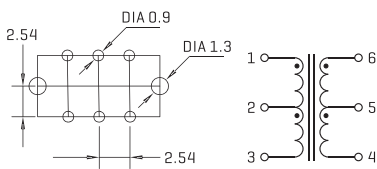

FAEP7-1

A

ELECTRICAL CHARACTERISTICS

Part No.	Inductance [10kHz/0.1V Typ]	Cs [max]	Turn Ratio	DCR[Ωmax]	THD [max]	Hi-pot [Pri-Sec]	Schematic
FAEP7-1	2.0mH min [1-3]	27pF [pri-sec]	1.66:1[1-3:6-4]	0.8:0.7[1-3:6-4]		1250VAC	A
FAEP7-2	530 μH±6% [6-4]	27pF [pri-sec]	1:1[1-3:6-4]	2.1:2.1[1-3:6-4]	-54dB	1250VAC	B
FAEP10	1.75mH min [8-2]	100pF [pri-sec]	1:0.653:0.184 [8-2:6-7:3-5]	0.9:0.58:0.09 [8-2:6-7:3-5]		500VDC	C

PHYSICAL CHARACTERISTICS

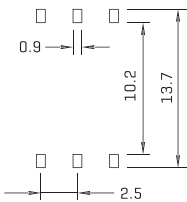

FAEP7-2

B

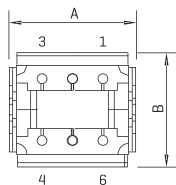

FAEP7-1

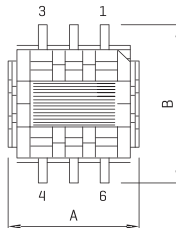
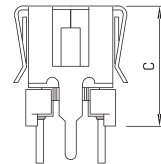

FAEP7-2

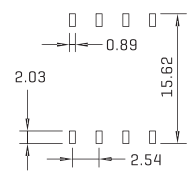
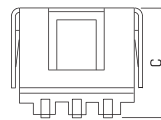

FAEP10

C

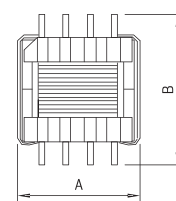

FAEP10

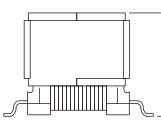

ALL DIMENSIONS IN MM

Part No.	FAEP7-1	FAEP7-2	FAEP10
A	10.5max	13.5max	24.4max
B	10.5max	13.5max	23.5max
C	11.0max	11.5max	11.6max

TELECOM TRANSFORMERS FAEP SERIES

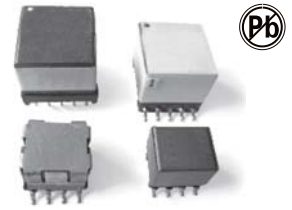

FEATURES

Low inFATERwind capacitance
Low total harmonic distortion[THD]
Compact size and Surface-mounted
Designed to meet UL, CSA, VDE, BABT safety standard

OPTIONS

Tape and reel is standard
Bulk packaging available for Smaller quantities
Custom design available
Tolerance: 5% is standard,
Tigh FATER tolerance available

COMMON APPLICATIONS

Modem
Fax machine, Hub
ISDN, ADSL, HDLSL, PABX
Other telecommunication facilities etc
Switching power supplies
AC-DC, DC-DC converters

TECHNICAL INFORMATION

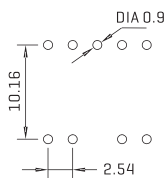

FAEP13-1

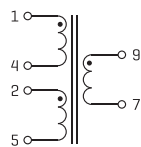

D

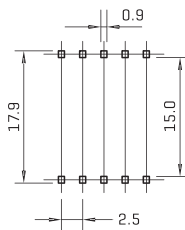

FAEP13-2

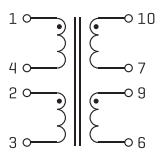

E

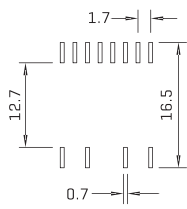

FAEP13-3

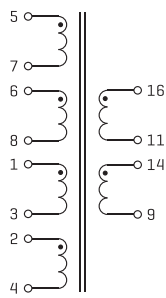

F

ELECTRICAL CHARACTERISTICS

Part No.	Inductance [10kHz/0.1V Typ]	Cs [max]	Turn Ratio	DCR[Ωmax]	THD [max]	Hi-pot [Pri-Sec]	Schematic
FAEP13-1	2.0mH±10% [1-5 tie 2, 4]		4:1 [1-5-9-7 tie 2,4]	1.25:1.25:1.0 [1-4:2-5:9-7]	-72dB	2050VAC	D
FAEP13-2	410 μH±6% [1-5 tie 2, 4]		2:1 [1-5:10-6 tie 2+4,7+9]	0.48:0.23 [1-4:10-7]	-72dB	1875VAC	E
FAEP13-3	400 μH ±6% [16-9 tie 11,14]	21pF [pri-sec]	4.25:1 [16-9:5-8 tie 11+14,7+6]	0.49:0.28:0.96 [14-9:5-7:1-3]	-68dB	1875VAC	F

PHYSICAL CHARACTERISTICS

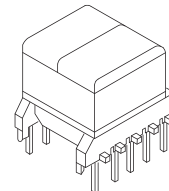
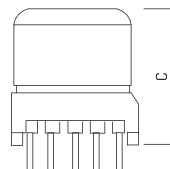
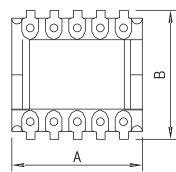

FAEP13-1

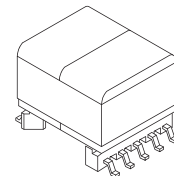
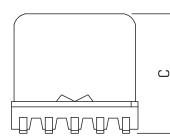
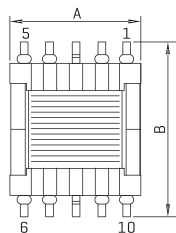

FAEP13-2

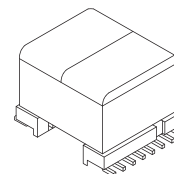
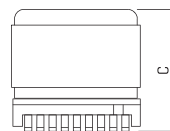
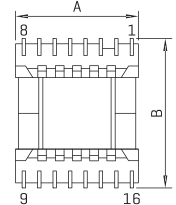

FAEP13-3

Part No.	FAEP13-1	FAEP13-2	FAEP13-3
A	14.2max	13.6max	14.0max
B	14.2max	17.9max	16.4max
C	13.0max	12.4max	12.6max

ALL DIMENSIONS IN MM